

ELECTROMANUAL TILTER (Drums and Eurobins) **EBT 300D**



- Hygienic innovative design
- Aggressive environments resistant chassis
- Robust and durable structure
- Electric Tilting
- Automatic Clamping
- IP65 Protected electronics

Inoxtruck tilters allow an ergonomic handling/casting of loads, thanks to the tilting system up to 130°. This equipment has an innovative design for drums that make possible an ergonomic handling tilting, reducing efforts. Their hygienic design become them into an ideal equipment for harsh environments due to the total cleaning of the equipment that reduce the microbiological pollution risk.



EBT300D

For plastic and metallic drums

 600 x h=1000



Hygienic Innovative Design

Curved and sloped structure for a perfect drainability and a fast drying. Totally opened chassis and forks, waterproof compartment for lifting system and the operator drives and controls with IP65 protections provide together with continuous welding top hygienic design, making possible a total cleaning, keeping the equipment in perfect working order.

Ergonomics and Efficiency

The handle ergonomics design and the existence of the emergency switch and push button in both sides allow right or left side operation, reducing efforts during the load transportation and tilting.

Furthermore, the funnel and tilting angle are adjustable, making possible to carry out different types of eurobin and work applications.

The automatic clamping to entry and remove the eurobin increases the ergonomics of these models.

100% Stainless steel

Manufactured 100% in stainless steel including all hydraulic equipment.

Minimum Maintenance

All moveable parts are supplied by free of lubrication polymeric bushings and the watertight batteries don't need maintenance.

Characteristics				
1.1	Manufacturer (Abreviation)		ULMA Inoxtruck	ULMA Inoxtruck
1.2	Manufacturer's model designation		EBT300D	EBT300D AC
1.3	Power source: battery, diesel, LP gas, petrol		Battery	1PH 230V 50Hz
1.4	Operator type: pedestrian, operator standing, seated		Pedestrian	Pedestrian
1.5	Load capacity	Q	kg	300
1.6	Load center distance	C	mm	300
1.8	Load wheel axle to fork face	X	mm	860
1.9	Wheelbase	Y	m	1340
1.10	Chassis		AISI 304L	AISI 304L
1.11	Sheet		AISI 304L	AISI 304L
Weight				
2.1	Truck weight with nominal load & maximum battery weight		kg	500
2.2	Axle loading nominal load & maximum battery weight, drive/load side		kg	225/275
2.3	Axle loading without load & maximum battery weight, drive/load side		kg	125/75
Wheels and Drive Train				
3.1	Tyres: P=Polyurethane, PA=Polyamide (nylon), Vul=Vulkollan, drive/load side		PA/PA	PA/PA
3.2	Tyres dimensions, drive side		160 X 40	160 X 40
3.3	Tyres dimensions, load side		80 X 67	80 X 67
3.5	Number of wheels, drive/load side (x=driven)		2/2	2/2
3.6	Track width (center of tyres), drive side	b10	mm	800
3.7	Track width (center of tyres), load side	b11	mm	800
Dimensions				
4.4	Overall height with tilted trolley	h4	mm	2580
4.9	Height of tiller arm	h14	mm	1020
4.15	Fork height, fully lowered	h13	mm	125
4.19	Overall length	l1	mm	1545
4.20	Length to fork face (includes fork thickness)	l	mm	570
4.21	Overall width	b1	mm	970
4.25	Outside width over forks	b5	mm	640
4.25b	base width	b5a	mm	600
4.32	Ground clearance at center of wheelbase	m2	mm	90
4.34a	Working aisle width (Ast) with 800 x 1200 mm pallets, load lengthwise	Ast	mm	2255
4.35	Turning circle radius	Wa	mm	1565
4.42	Tilted trolley height	ht	mm	1300
4.43	Tilting angle		°	130
Performance				
5.2	Tilting time, with/without load	s	20-25/15-20	20-25/15-20
5.3	Lowering speed, with/without load	s	15-20/15-20	10-15/10-15
Electric Motor				
6.2	Lift motor output at 15% duty factor	kW	0,8	0,75
6.4	Battery voltage/capacity C5	V/Ah	12/40	-
6.5	Battery weight	kg	17	-

Inoxtruck's products are constantly improving. Because of this reason, some materials, options and specifications can be changed without previous notification

*These times refer to the standard mechanism, modifications could create variations.

*Standard dimensions for 600 x 1000 drums

OPTIONS:

- Remote control
- Stainless steel AISI 316L
- Main power line supply 230 V

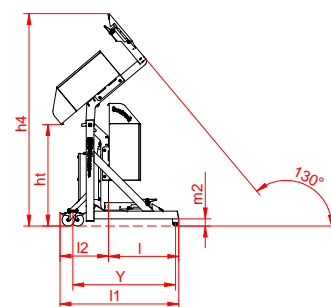
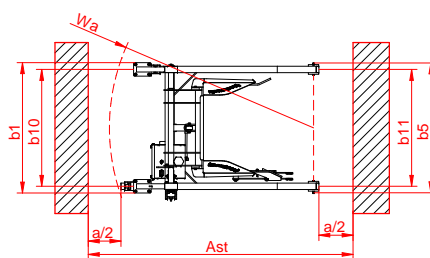

ULMA Servicios de Manutención S.Coop.

www.ulmainoxtruck.com

Paseo Otadui, nº 10
20560 OÑATI (Gipuzkoa)

T.: (+34) 943 84 89 43
info@ulmainoxtruck.com

**Engineered
by challenges**